

SGBJ3616

Features

- Glass passivated chip, high reliability
- Low forward voltage drop
- Insulation voltage: 2500V~

Application

- DC power supply
- Input rectifying of PWM converter
- Power supply of DC equipments

Characteristics

- Simple installation
- Smart size, Light weight
- Small heating resistance, high heat radiation, low temperature

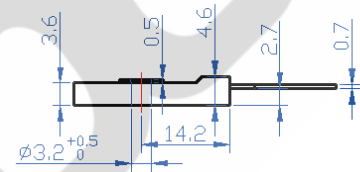
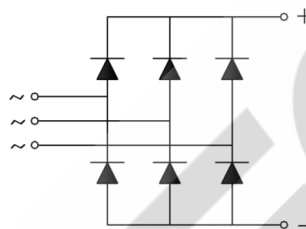
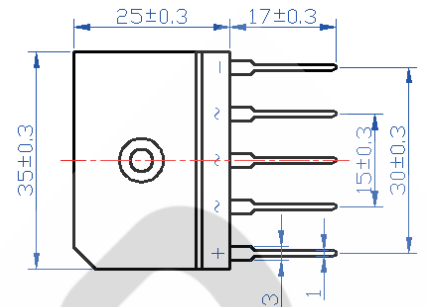

■ Max. value

Symbol	Rated				Unit
	SGBJ3510	SGBJ3512	SGBJ3514	SGBJ3516	
V_{RRM}	1000	1200	1400	1600	V
V_{RSM}	1100	1300	1500	1700	V

Symbol	Testing condition	Rated	Unit
$I_{F(AV)}$	180° sine anf half wave 50Hz, $T_c=100^\circ\text{C}$	35	A
I_{FSM}	$t=10\text{ms}, 50\text{Hz}, \text{sin}, T_j=25^\circ\text{C}$	400	A
I^2t		660	A^2S
V_{ISO}	50Hz, R.M.S, $t=1\text{min}, I_{iso}: 1\text{mA}(\text{Max})$	2500	V
T_j		-40 to +150	$^\circ\text{C}$
T_{jm}		150	$^\circ\text{C}$
T_{stg}		-40 to +125	$^\circ\text{C}$
M_d		0.8	$\text{N}\cdot\text{m}$
W_t		10	g

Symbol	Testing condition	Rated	Unit
I_{RRM}	$V_R=V_{RRM}, \text{ sine anf half wave}, T_j=25^\circ\text{C}$	5	μA
	$V_R=V_{RRM}, \text{ sine anf half wave}, T_j=150^\circ\text{C}$	3	mA
V_{FM}	$I_{FM}=17.5\text{A}, T_j=25^\circ\text{C}$	1.2	V
$R_{th(j-c)}$	single side cooling, sine anf half wave	0.96	$^\circ\text{C}/\text{W}$

SGBJ3616

正向特性曲线

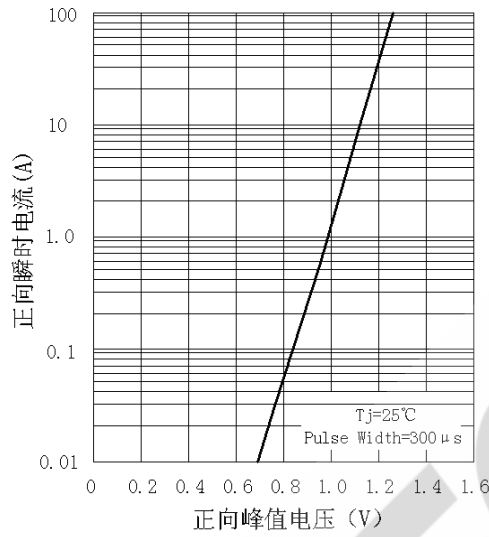

管壳温度与正向平均电流特性曲线

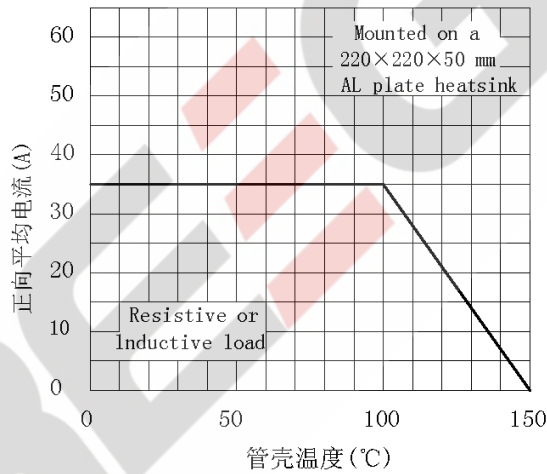

正向浪涌电流与周波数特性曲线

